

City of Mount Vernon, Ohio

# **CA&C Depot Site Improvements PID 2120509**

## **Addendum No. 1 June 13, 2024**

This addendum addresses the following issues:

**The following plan sheets have been revised:**

- Sheet 4 – General Notes & Quantities
- Sheet 7 – Site Plan

**Clarifications:**

1. Item 690 – Special – Swing Relocated, As Per Plan is no longer needed and should be bid at a price of \$0.00. This work will be performed by others. The price for excavating, prepping, and pouring the concrete swing pad shall be paid under Item 511 – Class QC1 Concrete, Misc.: Swing Foundation, As Per Plan. This pad shall be reinforced in the same way as the bench foundation detail found on Sheet 5.
2. The existing electronic display power supply may be utilized for the statue lighting provided a timer is installed.
3. The scope of work required at the existing basement window boxout under the drive awning will only include removal of the concrete pavement and will be paid under Item 202 – Pavement Removal, As Per Plan (Portland Cement Concrete). A separate contractor will work on the existing building foundation after pavement removal has been completed. Coordination of pavement removal with the building contractor shall be necessary and ensure both operations can occur in a safe and timely manner.
4. Limited geotechnical investigations have shown this site has an extremely high infiltration rate. The site has been filled with sand, gravel, cobblestone, bricks, and other material. The owner does not anticipate any dewatering activities will be necessary. However, the contractor shall

satisfy themselves of the site conditions and are strongly encouraged to visit the site before bidding.

5. The bricks used for the brick paver walk will be delivered by The City of Mount Vernon on pallets to the project location.
6. Once erected, the statue shall be covered for a grand reveal to happen once the project is completed.
7. The statue is 112" tall, 45" wide, 31" deep, and weighs approximately 1,500 pounds. The statue is one of a kind and cannot be replaced; therefore, a dollar value could not be associated with the statue.
8. The statue will be shipped to Building 5 at Heartland Commerce Park, located approximately at the former intersection of W Sugar St and N Norton St. The statue will be stored within a crate and will be loaded by the owner onto the contractor's truck.
9. The statue will not be equipped with mounting hardware or plates. The method for mounting the statue shall be coordinated between the contractor and The City of Mount Vernon.

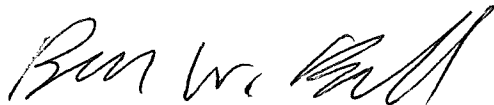

Brian W. Ball, P.E.  
City Engineer

40 Public Square  
Mount Vernon, OH 43050  
(740) 393-9528



**MAINTENANCE OF TRAFFIC (CONTINUED)**

**STREET CLOSING**

WHEN IT IS REQUIRED THAT THE STREET OR ROAD BE CLOSED TO THROUGH TRAFFIC, THE CONTRACTOR SHALL FURNISH, ERECT, MAINTAIN, AND REMOVE SIGNS, BARRICADES, ETC., AS PER THE ODOT AND THE MARION COUNTY ENGINEER. THE CONTRACTOR SHALL FURNISH, ERECT, AND MAINTAIN ADVANCE WARNING SIGNS, DETOUR SIGNS, AND BARRICADES, ETC. ON ALL STREETS INCLUDING SIDE STREETS IN THE AREA AFFECTED BY THE WORK.

CONTRACTOR SHALL SCHEDULE HIS WORK TO ENSURE THAT EACH ROAD CLOSING IS NO LONGER THAN SIX (6) HOURS AND OCCURS BETWEEN THE HOURS OF 9:00 A.M. TO 3:00 P.M. MONDAY THROUGH FRIDAY. THE CONTRACTOR SHALL MAKE SUITABLE PROVISIONS FOR ACCESS BY LOCAL RESIDENTS, SCHOOL BUSES, MAIL DELIVERY VEHICLES, POLICE, FIRE, AND EMERGENCY VEHICLES AT ALL TIMES.

THE CONTRACTOR SHALL FURNISH, ERECT AND MAINTAIN DETOUR MARKING SIGNS ON TEMPORARY ROUTES.

ADVANCE NOTICE OF ALL STREET CLOSINGS SHALL BE MADE TO THE COUNTY ENGINEER'S OFFICE AND THE LOCAL SCHOOL DISTRICT AND LOCAL MEDIA AT LEAST ONE WEEK PRIOR TO CLOSURE.

**SAFETY**

IF IN THE OPINION OF THE ENGINEER, PROPER MAINTENANCE OF TRAFFIC FACILITIES AND PROPER PROVISION FOR TRAFFIC CONTROL ARE NOT BEING PROVIDED AND THE SAFETY OF THE PUBLIC IS THUS ENDANGERED, THE OWNER MAY TAKE THE NECESSARY STEPS TO PLACE THEM IN PROPER CONDITION AND THE COST OF SUCH SERVICES WILL BE DEDUCTED FROM ANY MONEY WHICH MAY BE DUE THE CONTRACTOR.

**DRIVEWAYS**

NO DRIVEWAY IS TO BE CLOSED FOR MORE THAN FIVE (5) HOURS WITH THE TIME STARTING WHEN THE ENTRANCE IS CLOSED TO TRAFFIC. THE CONTRACTOR WILL BE RESPONSIBLE FOR NOTIFYING PROPERTY OWNERS, RESIDENTS, OR BUSINESS OPERATORS IN WRITING AT LEAST 24 HOURS BUT NOT MORE THAN 72 HOURS PRIOR TO CLOSURE. THE ENGINEER SHALL BE GIVEN A LIST OF THE BUSINESSES THAT WERE GIVEN NOTICES WITH THE DATE OF NOTICES INCLUDED. IF FOR ANY REASON THE FIVE (5) HOUR MAXIMUM LIMIT IS EXCEEDED ON ANY DRIVEWAY, THE CONTRACTOR WILL NOT BE PERMITTED TO CLOSE ANY FURTHER DRIVEWAYS UNTIL ALL CLOSED DRIVEWAYS ARE REOPENED. DRIVEWAYS SHALL NOT CLOSED DURING THE EVENING OR ON WEEKENDS UNLESS APPROVED BY THE CITY ENGINEER.

**COSTS**

COSTS FOR MAINTAINING TRAFFIC SHALL BE INCLUDED IN THE LUMP SUM PRICE BID FOR ODOT CMS ITEM 614 MAINTAINING TRAFFIC

**SUPPLEMENTAL ITEM NOTES**

**ITEM 201 - CLEARING AND GRUBBING, AS PER PLAN**

THE CONTRACTOR SHALL BE RESPONSIBLE FOR ALL REMOVALS, LABOR, TOOLS, MATERIAL, EQUIPMENT NECESSARY TO CLEAR AND GRUB ALL TREES, FENCE POSTS, ROCKS, BRUSH, STUMPS, AND FENCE SPECIFICALLY MARKED FOR REMOVAL THAT HAVE NOT BEEN ITEMIZED WITHIN THE CONSTRUCTION LIMITS OF THIS PROJECT. THE CITY OF MOUNT VERNON RESERVES THE RIGHT TO ORDER THE REMOVAL OF ANY RIGHT-OF-WAY ENCROACHMENT, ADDITIONAL TREES AND STUMPS LOCATED WITHIN THE RIGHT-OF-WAY, BUT NOT SHOWN ON THE PLANS.

THE CITY WILL PAY FOR ITEM 201 - CLEARING AND GRUBBING, AS PER PLAN AT THE CONTRACT UNIT PRICE OF LUMP SUM.

**ITEM 202 - PAVEMENT REMOVED, AS PER PLAN (ASPHALT CONCRETE)**

THIS ITEM SHALL BE PERFORMED PER ODOT SPEC 202.05. THE SECTION OF THE EXISTING ASPHALT PAVEMENT IS UNKNOWN. THE CONTRACTOR IS RESPONSIBLE FOR UNDERSTANDING THE EXISTING CONDITIONS AND SHALL BID THIS ITEM ACCORDINGLY.

**ITEM 202 - PAVEMENT REMOVED, AS PER PLAN (PORTLAND CEMENT CONCRETE)**

THIS ITEM SHALL BE PERFORMED PER ODOT SPEC 202.05. THE SECTION OF THE EXISTING PORTLAND CEMENT CONCRETE PAVEMENT IS UNKNOWN. THE CONTRACTOR IS RESPONSIBLE FOR UNDERSTANDING THE EXISTING CONDITIONS AND SHALL BID THIS ITEM ACCORDINGLY.

**ITEM 202 - ELECTRONIC SIGN REMOVED, AS PER PLAN**

THE BID PRICE FOR THIS ITEM SHALL INCLUDE ALL LABOR, MATERIALS AND EQUIPMENT REQUIRED FOR THE REMOVAL AND DISPOSAL OF THE ELECTRONIC SIGN AS INDICATED ON THE PLANS. THE CONTRACTOR IS RESPONSIBLE FOR THE DISCONNECTION OF THE SIGN FROM THE SOURCE OF POWER. ANY CABLE AND CONDUIT SHALL THEN BE PROPERLY ABANDONED OR REMOVED AT THE DIRECTION OF THE CITY OF MOUNT VERNON.

**ITEM 203 - EXCAVATION, AS PER PLAN (GRAVEL PARKING AREA)**

THE BID PRICE FOR THIS ITEM SHALL INCLUDE ALL LABOR, MATERIALS AND EQUIPMENT REQUIRED FOR THE EXCAVATION OF THE EXISTING GRAVEL PARKING AREA PER ODOT STANDARD SPECIFICATIONS AND AS SHOWN IN THE PLANS.

**ITEM 304 - AGGREGATE BASE, AS PER PLAN**

ESTIMATED QUANTITIES FOR ITEM 304 - AGGREGATE BASE, AS PER PLAN INCLUDE EXCAVATION OF EXISTING SUB-BASE MATERIAL. THE CONTRACTOR IS RESPONSIBLE FOR CONFIRMING WITH THE ENGINEER IF EXISTING SUB-BASE MATERIAL IS ACCEPTABLE. IF THE ENGINEER DETERMINES THAT THE EXISTING SUB-BASE MATERIAL IS NOT ACCEPTABLE, THE EXISTING MATERIAL SHALL BE REMOVED AND REPLACED WITH ACCEPTABLE AGGREGATE BASE MATERIAL.

**ITEM 452 - 8" FIBER-REINFORCED CONCRETE PAVEMENT, CLASS QC 1P, AS PER PLAN**

ALL MATERIALS AND WORK PERFORMED UNDER THIS ITEM SHALL CONFORM TO ODOT SPEC 452 EXCEPT AS MODIFIED WITHIN THESE PLANS. THE CONCRETE SHALL CONTAIN SYNTHETIC FIBERS FOR USE IN PORTLAND CEMENT CONCRETE PER ODOT SPEC 705.29. THE CONCRETE SHALL ALSO CONTAIN AN INTEGRAL CONCRETE SEALER PER ODOT SPEC 705.12 AND ASTM C494. THE ADMIXTURE USED SHALL BE PREMIERE CONCRETE ADMIXTURES IMPEDE INTRASEAL OR APPROVED EQUAL.

**ITEM 608 - 4" CONCRETE WALK, AS PER PLAN**

ALL SIDEWALK SHALL BE CONSTRUCTED IN STRICT ACCORDANCE WITH THE PUBLIC RIGHT OF WAY ACCESSIBILITY GUIDELINES (PROWAG) AS WELL AS THE CITY OF MOUNT VERNON RESIDENTIAL CONCRETE SIDEWALK DETAIL. FINAL ACCEPTANCE AND COMPLIANCE WITH PROWAG GUIDELINES SHALL BE THE SOLE RESPONSIBILITY OF THE CONTRACTOR. ALL CURB RAMPS OR ASSOCIATED WORK FOUND TO BE NON-COMPLIANT WITH PROWAG GUIDELINES SHALL BE REMOVED AND RECONSTRUCTED BY THE CONTRACTOR TO MEET PROWAG REQUIREMENTS AT NO ADDITIONAL COST TO THE CITY OF MOUNT VERNON.

THE BID PRICE FOR THIS ITEM SHALL INCLUDE ALL LABOR, MATERIALS AND EQUIPMENT REQUIRED FOR THE INSTALLATION OF THE PROPOSED CONCRETE WALK ACCORDING TO PROWAG GUIDELINES AND THE CITY OF MOUNT VERNON RESIDENTIAL CONCRETE SIDEWALK DETAIL.

**ITEM 608 - DETECTABLE WARNING, AS PER PLAN**

ALL DETECTABLE WARNINGS SHALL BE 2' X 4' CAST IRON TRUNCATED DOMES OR A SUITABLE ALTERNATIVE APPROVED BY THE CITY ENGINEER.

**ITEM 611 - 4" CONDUIT, TYPE B, AND ITEM 611 - 4" CONDUIT, TYPE C**

THE BID PRICE FOR THIS ITEM SHALL INCLUDE ALL LABOR, MATERIALS AND EQUIPMENT REQUIRED FOR THE INSTALLATION OF THE PROPOSED STORM SEWER PER ODOT STANDARD SPECIFICATIONS AND AS SHOWN IN THE PLANS. GRAVITY SEWERS SHALL BE ASTM D-3034, SDR 35 PVC WITH GASKETED JOINTS PER ASTM D-3212 AND BEDDING PER ASTM CLASS 1 OR CLASS II.

ALL GRAVITY SEWERS AND LATERALS MUST BE TESTED IN ACCORDANCE WITH THE CITY OF MOUNT VERNON STANDARDS AND SPECIFICATIONS. ANY PIPING NEEDING REPLACED DUE TO

FAILING TESTS SHALL BE REPLACED BY THE CONTRACTOR AT NO ADDITIONAL COST TO THE CITY OF MOUNT VERNON.

**ITEM 659 - TOPSOIL, AS PER PLAN**

THE BID PRICE FOR THIS ITEM SHALL INCLUDE ALL LABOR, MATERIALS AND EQUIPMENT REQUIRED FOR THE PLACEMENT OF TOPSOIL IN THE GRAVEL PARKING AREA TO BE EXCAVATED. THE ODOT ITEM 659 AND STANDARD SPECIFICATIONS SHALL GOVERN THIS WORK.

**SPECIAL - STATUE TRANSPORTED, AS PER PLAN**

THE BID PRICE FOR THIS ITEM SHALL INCLUDE ALL LABOR, MATERIALS, AND EQUIPMENT REQUIRED FOR THE TRANSPORTATION OF THE STATUE FROM BUILDING 5 OF HEARTLAND COMMERCE PARK TO THE PROJECT LOCATION. THE CONTRACTOR IS RESPONSIBLE FOR INSPECTION OF THE STATUE UPON ARRIVAL TO CONFIRM THERE IS NO DAMAGE OR DEFECTS. THE CONTRACTOR IS ALSO RESPONSIBLE FOR THE SAFE TRANSPORT, LOADING, AND UNLOADING OF THE STATUE. THE CONTRACTOR IS LIABLE FOR ANY DAMAGES INCURRED AS A RESULT OF TRANSPORT, LOADING, OR UNLOADING AND SHALL REPLACE THE STATUE AT NO COST TO THE CITY OF MOUNT VERNON. ONCE THE CONTRACTOR IS READY FOR TRANSPORT OF THE PROPOSED STATUE THEY SHALL COORDINATE WITH THE MAINTENANCE PERSONNEL OF HCP LISTED BELOW:

STEVE BENEDICT  
HEAD OF MAINTENANCE  
T:(740)504-1164

**SPECIAL - STATUE PEDESTAL, AS PER PLAN**

THE BID PRICE FOR THIS ITEM SHALL INCLUDE ALL ENGINEERING, LABOR, MATERIALS, AND EQUIPMENT REQUIRED FOR THE DESIGN, PROCUREMENT, AND ERECTION OF THE STATUE PEDESTAL. THE PEDESTAL FOR THE PROPOSED STATUE SHALL BE A DECORATIVE PRECAST OR CAST-IN-PLACE CONCRETE PEDESTAL. THE CONTRACTOR IS RESPONSIBLE FOR OBTAINING A P.E. STAMPED SHOP DRAWING SUBMITTAL AND SUBMITTING TO THE CITY OF MOUNT VERNON FOR REVIEW AND APPROVAL. IT IS THE RESPONSIBILITY OF THE CONTRACTOR TO OBTAIN ANY FEDERAL OR STATE PERMITS REQUIRED.

**SPECIAL - FLAG POLE, AS PER PLAN**

THE BID PRICE FOR THIS ITEM SHALL INCLUDE ALL LABOR, MATERIALS, AND EQUIPMENT REQUIRED FOR THE PROCUREMENT AND ERECTION OF THE PROPOSED 30-FT TALL FLAG POLE. THE FLAG POLE SHALL BE ALUMINUM AND OF ONE PIECE CONSTRUCTION. FLAG POLE TO BE USED ALONG WITH A DETAIL OF THE CONCRETE BASE SHALL BE SUBMITTED TO THE CITY OF MOUNT VERNON FOR APPROVAL.

**SPECIAL - BENCH, AS PER PLAN**

THE BID PRICE FOR THIS ITEM SHALL INCLUDE ALL LABOR, MATERIALS, AND EQUIPMENT REQUIRED FOR THE PROCUREMENT AND ERECTION OF THE BENCH. THE BENCH SHALL BE A 6' LONG DUMOR 58-60 SERIES.

**SPECIAL - SWING RELOADED, AS PER PLAN**

THE BID PRICE FOR THIS ITEM SHALL INCLUDE ALL LABOR, MATERIALS, AND EQUIPMENT REQUIRED FOR THE RELOCATION, ERECTION, AND ANCHORING OF THE CUSTOM METAL FABRICATED SWINGS FROM CUSTOM-CUTTERS AT 8924 COLUMBUS RD TO THE AREAS AS SHOWN ON THE PLANS. THIS WORK SHALL BE COORDINATED WITH THE CITY OF MOUNT VERNON AND CUSTOM CUTTERS.

**SPECIAL - STATUE INSTALLED, AS PER PLAN**

THE BID PRICE FOR THIS ITEM SHALL INCLUDE ALL LABOR, MATERIALS, AND EQUIPMENT REQUIRED FOR THE ERECTION, INSTALLATION, AND SECUREMENT OF THE PROPOSED STATUE TO THE PROPOSED STATUE PEDESTAL. THE PROPOSED STATUE SHALL BE PROVIDED BY THE CITY OF MOUNT VERNON AND WORK SHALL BE COORDINATED WITH THE CITY PRIOR TO STARTING. IT IS THE RESPONSIBILITY OF THE CONTRACTOR TO OBTAIN ANY FEDERAL OR STATE PERMITS REQUIRED TO COMPLETE THIS WORK.

**SPECIAL - BRICK PAVER WALK, AS PER PLAN**

THE BID PRICE FOR THIS ITEM SHALL INCLUDE ALL LABOR AND EQUIPMENT REQUIRED FOR THE CONSTRUCTION OF THE BRICK PAVER WALK. THE BID PRICE SHALL ALSO INCLUDE THE LABOR, MATERIAL, AND EQUIPMENT REQUIRED TO SET THE MASONRY LEVELING SAND. THE BRICK PAVEMENT WALK SHALL BE CONSTRUCTED PER CITY OF MOUNT VERNON SPECIFICATIONS AND DETAILS FOUND ON THESE PLANS. BRICK PAVERS WILL BE SUPPLIED BY THE CITY OF MOUNT VERNON.

**SPECIAL - LANDSCAPING**

THE BID PRICE FOR THIS ITEM SHALL INCLUDE ALL LABOR AND EQUIPMENT REQUIRED FOR THE CONSTRUCTION OF THE LANDSCAPED AREA SURROUNDING THE PROPOSED STATUE PEDESTAL. THE LANDSCAPING SHALL INCLUDE MULCHING AND PLANTING OF SHRUBS. THE TYPES AND MATERIALS SHALL BE SPECIFIED BY THE CITY OF MOUNT VERNON AT A LATER DATE.

**SPECIAL - STATUE LIGHTING**

LIGHTING SHALL ILLUMINATE THE PROPOSED STATUE AND FLAG POLE AT NON-SUNLIGHT HOURS. THE LIGHTS SHALL BE SET ON A TIMER AND SOLAR POWERED. LIGHTING SHALL BE SUBMITTED TO THE CITY OF MOUNT VERNON PRIOR TO INSTALLATION.

**EROSION CONTROL, AS PER PLAN**

THE BID PRICE FOR THIS ITEM SHALL INCLUDE EROSION CONTROL PERFORMED PER THE EROSION CONTROL PLAN AND NOTES ON SHEETS 10 AND 11 OF THIS PLAN. THE SITE SHALL BE CONTAINED BY COMPOST FILTER SOCK INSTALLED PER PLAN. THE COMPOST FILTER SOCK WILL BE PROVIDED BY THE CITY OF MOUNT VERNON. BEFORE CONSTRUCTION COMMENCES THE FILTER SOCK CAN BE PICKED UP AT HEARTLAND COMMERCE PARK. THE CONTRACTOR SHALL COORDINATE THE PICK-UP OF MATERIALS WITH THE MAINTENANCE PERSONNEL OF HCP LISTED BELOW:

STEVE BENEDICT  
HEAD OF MAINTENANCE  
T:(740)504-1164

QUANTITIES

ITEM	ITEM EXT.	DESCRIPTION	TOTAL	UNIT
DEMOLITION				
201	11000	CLEARING AND GRUBBING, AS PER PLAN	1	LS
202	23001	PAVEMENT REMOVED, AS PER PLAN (ASPHALT CONCRETE)	1,950	SY
202	23001	PAVEMENT REMOVED, AS PER PLAN (PORTLAND CEMENT CONCRETE)	55	SY
202	30000	WALK REMOVED	380	SF
202	98100	ELECTRONIC DISPLAY SIGN REMOVED, AS PER PLAN	1	EA
SITE IMPROVEMENTS				
103	06000	PREMIUM FOR CONTRACT PERFORMANCE BOND, PAYMENT BOND AND MAINTENANCE BOND	1	LS
203	10001	EXCAVATION, AS PER PLAN	306.0	CY
204	10000	SUBGRADE COMPACTION	2,900	SY
304	20001	AGGREGATE BASE, AS PER PLAN*	453	CY
305	17500	5" CONCRETE BASE, AS PER PLAN (BRICK PAVER WALK)	54	SY
452	12011	8" FIBER-REINFORCED CONCRETE PAVEMENT, CLASS QC 1P, AS PER PLAN	2,610	SY
511	53010	CLASS QC1 CONCRETE, MISC.: BENCH FOUNDATION, AS PER PLAN	2.3	CY
511	53010	CLASS QC1 CONCRETE, MISC.: SWING FOUNDATION, AS PER PLAN	3.3	CY
608	10001	4" CONCRETE WALK, AS PER PLAN	1,390	SF
608	53021	DETECTABLE WARNING, AS PER PLAN	4	EA
609	23000	CURB, TYPE 6	132	FT
611	01800	8" CONDUIT, TYPE B	197	FT
611	02000	8" CONDUIT, TYPE C	20	FT
611	99900	DRAINAGE STRUCTURE, MISC.: INFILTRATION MANHOLE, AS PER PLAN	1	EA
624	10000	MOBILIZATION	1	LS
630	01100	GROUND MOUNTED SUPPORT, NO. 1 POST	2	EA
630	80101	SIGN, FLAT SHEET, AS PER PLAN	2	EA
646	10400	STOP LINE	10	FT
646	10600	TRANSVERSE/DIAGONAL LINE	371	FT
646	10900	HANDICAP SYMBOL MARKING	2	EA
646	20200	PARKING LOT STALL MARKING	735	FT
659	00301	TOPSOIL, AS PER PLAN	306	CY
659	10001	SEEDING AND MULCHING, AS PER PLAN	1,725	SY
690	50500	SPECIAL - CONCRETE PARKING BLOCK	6	EA
690	98000	SPECIAL - STATUE TRANSPORTED, AS PER PLAN	1	EA
690	98000	SPECIAL - STATUE PEDESTAL, AS PER PLAN	1	EA
690	98000	SPECIAL - FLAG POLE, AS PER PLAN	1	EA
690	98000	SPECIAL - BENCH, AS PER PLAN	3	EA
<del>690</del>	<del>98000</del>	<del>SPECIAL - SWING RELOADED, AS PER PLAN</del>	<del>3</del>	<del>EA</del>
690	98000	SPECIAL - STATUE INSTALLED	1	EA
690	98200	SPECIAL - BRICK PAVER WALK (LABOR ONLY), AS PER PLAN	480	SF
690	98400	SPECIAL - LANDSCAPING	1	LS
690	98400	SPECIAL - STATUE LIGHTING	1	LS
832	30000	EROSION CONTROL, AS PER PLAN	1	LS

\*DENOTES CONTINGENCY ITEM, AS DIRECTED BY THE ENGINEER

CALCULATED  
QEP  
CHECKED  
BWB

GENERAL NOTES & QUANTITIES

CITY OF MOUNT VERNON, OHIO  
ENGINEERING DEPARTMENT



\\dc01-eng\Network\_Share\ENGINEERING\CURRENT\_PROJECTS\CA&C Project.AF PID 509 - 2120509\DESIGN\CAD Plans\City of Mount Vernon\CA&C Depot CAD\_BM\_P\_Phase 1.dwg 10:24 AM

**LEGEND**

- - - - -	EX EDGE OF PAVEMENT
- - - - -	EX EDGE OF WALK
- - - - -	EX EDGE OF SHARED USE PATH
- - - - -	EX EDGE OF WATER
- SAN - - - - -	EX SANITARY
- W - - - - -	EX WATER
- G - - - - -	EX GAS
- E - - - - -	EX UNDERGROUND ELECTRIC
- OH-E - - - - -	EX OVERHEAD ELECTRIC
SAN	PR SANITARY
W	PR STORM
W	PR WATER
E	PR UNDERGROUND ELECTRIC
[Hatched Box]	PR PAVEMENT MARKING
[Solid Box]	PR CONCRETE PAVEMENT
[Dotted Box]	PR CONCRETE WALK
[Brick Pattern Box]	PR PAVER WALK
[Red Dotted Box]	PR TOPSOIL, SEED & MULCH

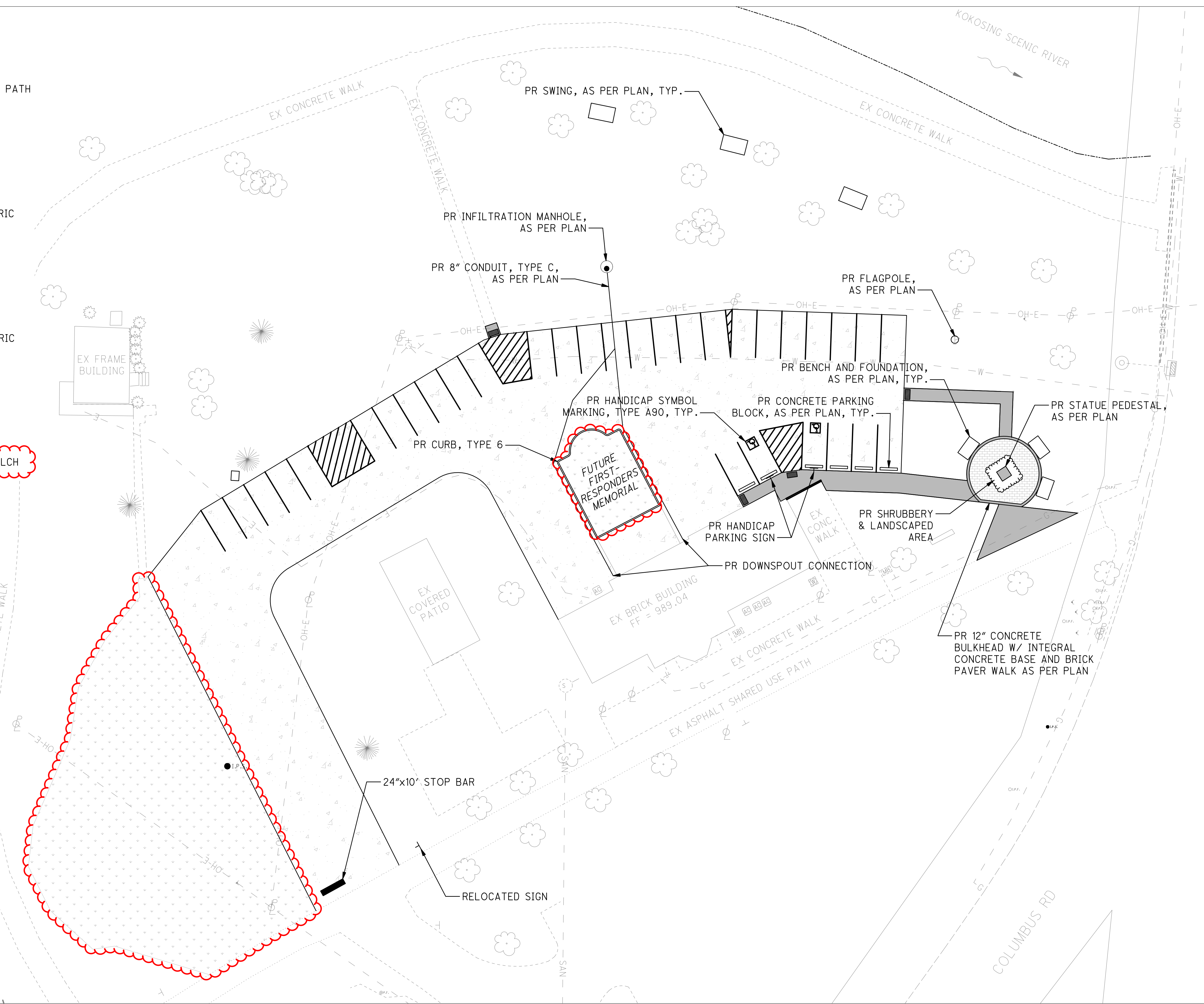

CALCULATED  
O.E.P.  
CHECKED  
BWB

0 20 40 80  
HORIZONTAL  
SCALE IN FEET

**CA&C RAILROAD DEPOT SITE IMPROVEMENTS  
SITE PLAN**

CITY OF MOUNT VERNON, OHIO  
ENGINEERING DEPARTMENT